

JZ-501
HOTEL LOCK SYSTEM

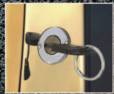

Mechanical key



Back locking when handle lifted



Open with intelligent card



American standard lock core

Jezi
HOTEL LOCK SYSTEM



JZ-501-Y



JZ-501-J

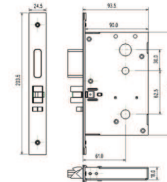
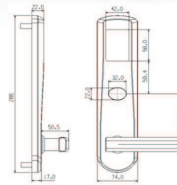

FUNCTIONAL CHARACTERISTICS

1. Professional design and high quality
2. Inner and outer handle "Dissociation" function
3. Patent detached two-gear clutch device, Good stability
4. Open by intelligent inductive cards or mechanical key
5. American standard lock core, sturdy and durable
6. Low voltage alarm function
7. Japan motor more than 50000 lifetimes.
8. Patent detached two-gear clutch device to guarantee the durability of mortise.
9. Application:Star hotel,hospital,school,modern office.

TECHNOLOGY REFERENCE

Dimension of product	265L*74W*23H(mm)
Usage voltage	DC6V, 4 Alkaline Battery
Static current	≤20 μ A
Dynamic current	≤200mA
Working temperature	-20℃ ~ +60℃
Working humidity	10% ~ 85%RH
Lock shell	SUS304 stainless steel
Handle	SUS304 stainless steel
Card technology	EM card/T5557 card/Mifare1 card